



THE CROQUE-MONSIEUR

QUATUOR 'DWICH XL

—
User manual

frifri[★].BE



ENVIRONMENTAL PROTECTION

NORM 2002/96/CE

In order to protect our environment and your health, disposal at the end of the lifetime of electric appliances must be treated under certain rules and this requires involvement of everyone, supplier or user. Therefore, your appliance cannot in any way be disposed in a public waste bin or with normal domestic waste, as indicated by the symbol on the rating plate. When disposing of the appliance it is your responsibility to bring the appliance to an official collection center for recycling of electric and electronic appliances. For more information on the collection centers for recycling of appliances at the end of their lifetime, please contact the local authorities in your area, the household waste disposal service provider or the store where you bought your appliance.

ELECTRICAL CORD

Carefully check the electrical cord before each use. If it is damaged, do not use the appliance. The electrical cord can only be replaced by Dalcq S.A., her after sales service or a capable and authorized person in order to avoid any danger for the user. The electrical cord used is a HO5VV-F 3 G 0,75 mm². These appliances comply to the 2006/95/ CE, 2004/108/CE, DEEE 2002/96/CE, rohs 2002/95/ CE norms and the 1935/2004 regulation of the European Parliament on materials and articles intended to come into contact with food.

SAFETY PRESCRIPTIONS

Carefully read the user manual before using the appliance and keep it in order to consult later if needed.

- This appliance shall not be used by persons (including children under the age of 8) whose physical, sensorial or mental capacities are reduced, nor by persons lacking experience or knowledge, except when having received supervision or instructions from another person responsible for their security about the use of this appliance in advance
- Maintenance and cleaning of the appliance cannot be carried out by children
- Never operate the appliance unattended
- This appliance is designed to be used domestically. The manufacturer declines all responsibility for all accidents caused by an incorrect use of the appliance or if it is not used as prescribed in this user manual
- Never pull the electrical cord to unplug the appliance, but hold the socket
- Keep the electrical cord away from sharp edges, hot surfaces or other heat sources
- Never place the appliance on a hot surface or close to a flame
- If your appliance or its electrical cord are damaged, never use it and contact the after sales service
- All repairs must be executed by a center certified by the manufacturer or its after sales service

- Never let the appliance plugged in when not in use

- Never use separate timers or remote controls

- Never immerse your appliance in water or any other liquid

- The temperature of the accessible parts can be high while operating. Never touch the hot surfaces while operating

- Never move the appliance when it is hot
- Allow the appliance to cool down before cleaning it

- Place the appliance on a flat and dry surface

- Never use the appliance in a confined area

- Never place the appliance on another appliance

- Never put any of the parts of the appliance in the microwave oven

- For your safety, it is recommended never to use your appliance outside or on a place exposed to humidity or weather conditions

- Always use the appliance for what it is intended



DESCRIPTION OF THE APPLIANCE



Technical features

- Baking plates with non-stick coating
- Extra-large mold for sandwiches
- 1600 Watts
- Non-skid feet

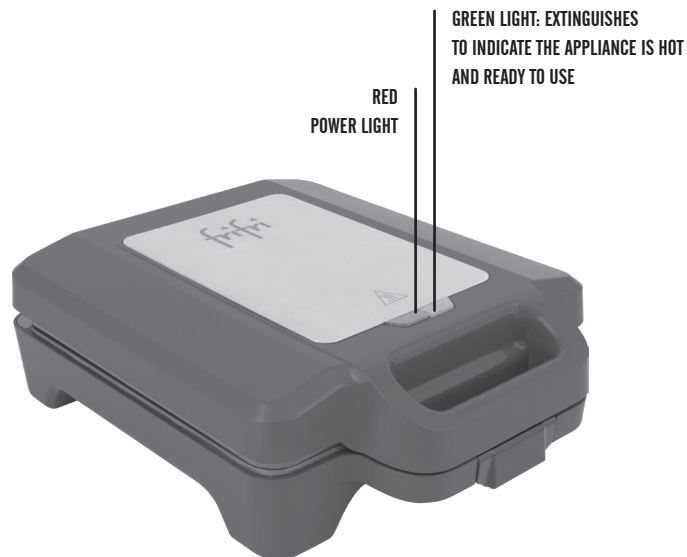

PUTTING INTO SERVICE AND USE

Before the first use

- Remove all packaging material from the appliance
- Carefully clean the appliance
- Upon first use, there might be a slight odor output, therefore, let the appliance warm for 5 minutes to remove possible residues
- Upon first use, clean the baking plates and pour some oil on the plates

Use of the croque monsieur Quatuor D'wich XL

- Place the appliance on a heat resistant surface and make sure there is enough ventilation around the appliance.
Do not place the appliance on an untreated wooden surface
- Plug in the appliance, the red and green light light up
- Let the appliance heat up for about 2 to 5 minutes, until the green light extinguishes, which indicates the appliance is hot enough to start baking
- Lift the safety lock to open the appliance and put your food in
- Close the appliance and progressively squeeze the handles in order for the bread to seal correctly. Bake for 3 to 4 minutes depending on the desired baking result
- To remove the food from the appliance when it is baked to your taste, use wooden or plastic kitchen utensils in order not to damage the non-stick coating from the baking plates

- Once finished, unplug the appliance and allow the appliance to cool down before cleaning it

Maintenance

- Always turn off and unplug the appliance before cleaning it
- Never immerse the appliance in water, or put it in the dishwasher
- All external surfaces can be cleaned with a soft cloth or sponge

Garantie

Dalcq S.A. provides a special warranty on all parts of the appliance subject to conditions below. The legal regulations about warranty as well as the rights resulting from the legislation about responsibility of the defective products remain unaffected. Possible right to reimbursement of the buyer in case of defaults remain valid, if the conditions below are met.

1. Period of the warranty

The warranty applies to all parts of the appliance and starts from the date of purchase (date of invoice) of the appliance and has a duration of 2 years when used privately.

2. Object of the warranty

Dalcq S.A. covers the material, construction and manufacturing defaults, provided the default was present at delivery and that the appliance was correctly operated by the buyer. The warranty covers free repair, or exchange of one or more defective components, or the exchange of the appliance for another appliance of the same value. It is up to Dalcq S.A. to

decide which measure to undertake.

3. Warranty case

When breakdown/default, you must immediately advise:

- The store where you bought the appliance
- The after sales service (written or via email) that the appliance will be returned, to provide an extended description of the problem with pictures

4. Packaging

It is recommended to use the original packaging to return the appliance. If you use a different packaging, make sure it provides enough protection for typical transport risks and that it offers sufficient protection.

A simple cardboard box filled with paper is not sufficient. Dalcq S.A. cannot be held responsible for damage resulting from insufficient packaging. The warranty then expires. The after sales service will inform you of the return procedure as well as of the costs this implies.

5. Cleaning

If you don't clean the parts or the appliance before returning it, Dalcq S.A. will invoice a cleaning set rate. It is the responsibility of the buyer to prove the real costs of cleaning are inferior to the invoiced set rate.

6. Withdrawal of the right to warranty

The right to warranty is withdrawn by :

- Incorrect use, treatment and storage.
(for example, defaults caused by humidity, high temperatures)
- Repairs, repair attempts, modifications of any kind and use of non-original parts, etc. which were not executed by Dalcq S.A. or by an authorized company

- Insufficient packaging and bad transport
- Inappropriate mechanical influences on the appliance or on the parts of the appliance
- Defaults that are not caused by the finishing or production of the appliance, such as fall, collision, damage, fire, earthquake, damage by flood, lightning, etc
- Use other than household use, especially in a commercial environment
- The costs incurred by Dalcq S.A. because of the returning of the appliance by the buyer, without warranty or right to restitution will be for the buyer

7. After sales service

Dalcq S.A. - Rue du Hainaut 86

6180 Courcelles - Belgium

support@dalcq.com



frifri.BE