

# THE MIXEUR MIX'SAVER

User manual

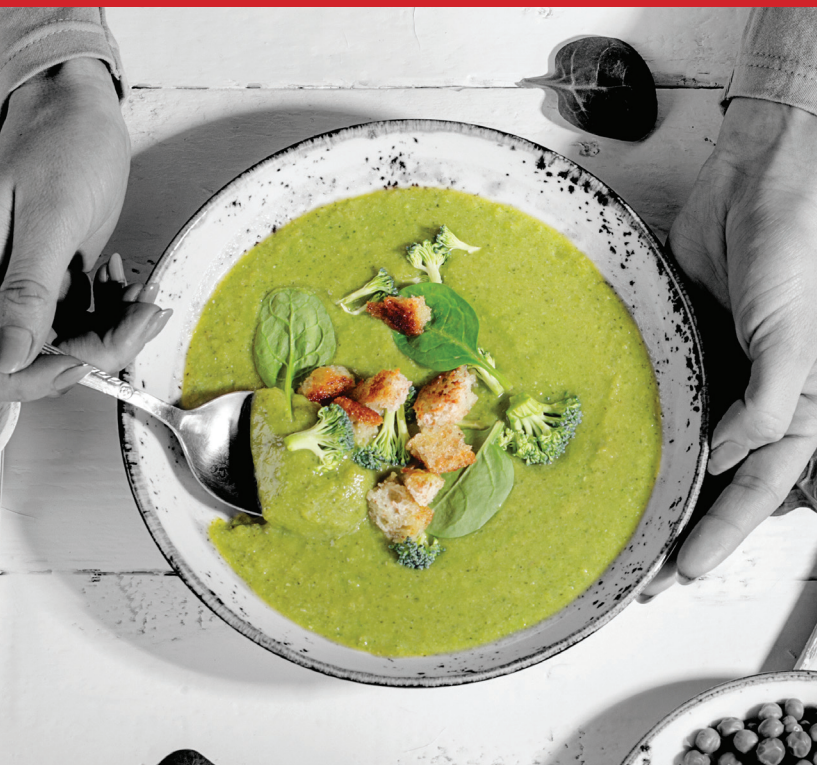

## **SAFETY PRESCRIPTIONS**

- This appliance may not be used by persons (including children under the age of 8) whose physical, sensorial or mental capacities are reduced, nor by persons lacking experience or knowledge, except when having received supervision or instructions from another person responsible for their security about the use of this appliance in advance
  - Maintenance and cleaning of the appliance may never be done by children.
- Keep the appliance and the electrical cord out of reach of children under the age of 16
- There is a risk of injuries when the appliance is used incorrectly
  - Never operate the appliance unattended or leave it plugged in when not in use
  - If the appliance is used incorrectly, or for professional purposes, or if it is not used as prescribed in the user manual, the warranty shall expire, and we could be entitled to decline all responsibility for possible damage
  - Before plugging in the appliance, check if the voltage indicated on the appliance matches the mains voltage of your house
  - Make sure your hands are dry before unplugging the appliance
  - Turn off and unplug the appliance before changing accessories
  - Carefully handle the sharp blades, while putting them into place or cleaning
  - Completely unroll the electrical cord
  - Do not pull the electrical cord to remove the plug from the socket, but hold the plug
  - Keep the electrical cord away from sharp edges, hot surfaces or other heating sources
  - Never place your appliance on hot surfaces or in near a flame
  - Never use the appliance if the electrical cord is damaged, contact the after sales service
  - For your own safety, only use accessories and parts suited for your appliance.
- All repairs must be executed by a company authorised by the manufacturer or its after sales service (see information at the end of this document). Do not try to open the motor block or to repair the appliance yourself
- When overheated, the motor will engage the safety system.
- Turn off the appliance and wait until the motor has completely cooled down
- This appliance is not meant to be used with separate timers or a remote control
  - Never immerse the appliance nor the electrical cord in water or any other fluid
  - Never put any part of the appliance in the microwave oven
  - For your own safety it is recommended never to use or store the appliance outside or on places exposed to weather conditions or humidity
  - Only use this appliance for what it is intended

Congratulations ! You are the happy owner of a new mixer :  
**THE ESSENTIAL MIX'SAVER** from Frifri. Carefully read the user manual before using  
 the appliance and keep it in order to consult later if needed.

## DESCRIPTION DU MIXEUR MIX'SAVER

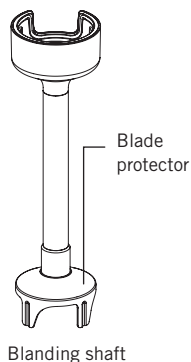
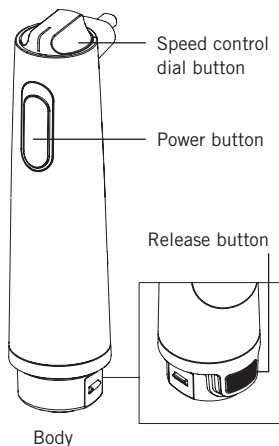

## BLADES & ALL-IN-ONE STAND



Multi Blade (Titanium coating) :  
 Mix/Grind ingredients (carrots, tomatoes,  
 ice, green vegetables...)



Meat and Vegetable Blade:  
 Cut/Chop (Meat, fish, onion...)



Beater : Whipping/Mixing ingredients  
 (eggs, mayonnaise, cream, ...)



Blade  
remover



2 in 1 stand: stand for  
 blades and support for  
 the mixer

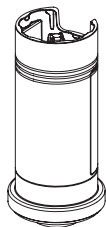

Vacuumizer



Whisk



Cup 900ml



Vacuum bag (x 3)

## TECHNICAL FEATURES

- 600 Watt
- Voltage : 220-240V ~ 50Hz

## PUTTING INTO SERVICE & USE

### Before the first use

Make sure your appliance is not plugged in before following instructions below.

### Assemble and disassemble the blades

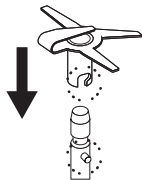

#### Assemble

To assemble the desired blades, make sure the groove is in line with the rotor pin.

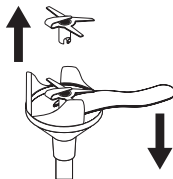

#### Disassemble

Put the blade remover as indicated on the drawing and use it as lever to remove the blades. (Never try to remove the blades with your hands. This could cause serious injuries).

## Assemble and disassemble the mixer and the vacuumizer

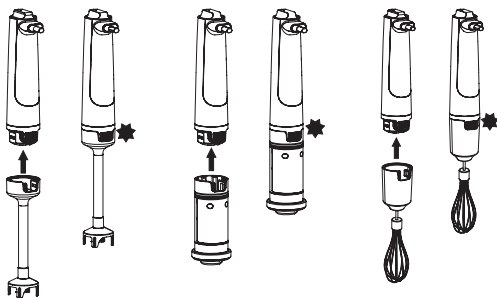

### Assemble

Votre Your appliance fits on the blending shaft as well as the vacuumizer and the whisk. To attach the body to one of these elements, align the groove and the release button until you hear a 'click'. If the appliance is not assembled correctly, this might cause problems.

### Disassemble

Press the release button at the back of the body, to remove the vacuumizer or whisk. Check the positioning of the blades before use. If necessary, adjust them, because incorrect fixed blades could come loose and mix with your ingredients. To clean the appliance before the first use, operate the mixer for 30 seconds in a bowl of clean water.

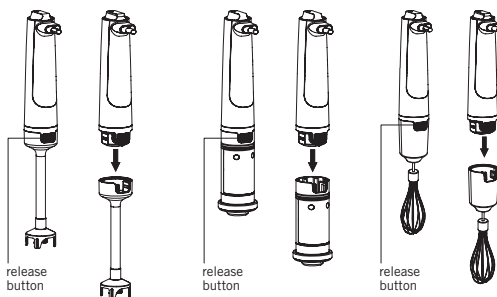

## USE OF THE ESSENTIAL MIX'SAVER MIXER

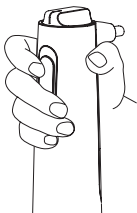

### THE MIXER

Hold the body and press the power button to start and release the power button to stop. You can adjust the rotating speed from 1 to 5, before or during operating.

To avoid splashes :

1. The blades must be completely immersed in the ingredients
2. During operation, if you need to add ingredients, add them slowly while moving the appliance vertically

### THE VACUUMIZER

The rubber device, reversible, allows 2 different openings that adapt to your needs.

To vacuumize reusable vacuum bags

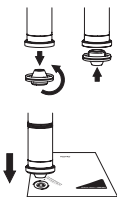

1. Place your ingredients in the bag and close the bag correctly with the zipper
2. Place the ESSENTIAL MIX'SAVER vertically on the round opening of the bag
3. Start the appliance by turning the speed control dial button to position 1 (also called VACCUM POSITION)
4. Press the power button to start the appliance and vacuumize the bag

To vacuumize a fresh container

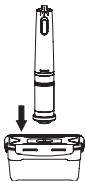

1. Place the ingredients in the fresh container and close with the lid
2. Place the ESSENTIAL MIX'SAVER vertically on the opening of the fresh container
3. Start the appliance by turning the speed control dial button to position 1 (also called VACCUM POSITION)
4. Press the power button to start the appliance and vacuumize the fresh container

The vacuumizer works on a constant speed.

To vacuumize, always set the speed control dial button on position 1 (VACUUM).

If you use another position than position 1, this could damage the appliance.

## MAINTENANCE

### THE MIXER & THE WHISK

It is recommended to operate your mixer for 30 seconds in a bowl of clean water before and after every use to clean it. Unplug the appliance after cleaning. Dry the appliance with a dry and clean cloth. Never immerse the body nor the removable parts into water to avoid any risk of defect.

### THE VACUUMIZER

Clean the lid of the accessory with a clean moist cloth, never clean the vacuumizer in water to avoid any risk of defect.

### TROUBLESHOOTING

Failure	Solution
The motor is working, but the knives aren't	Rests of ingredients have crystallized inside, because of insufficient cleaning or long storage. Unplug the appliance, immerse the blades and the blade cover in hot water for approximately 30 minutes and operate the blades in clean water. (Never allow water into the body of the appliance)
The speed of the vacuumizer cannot be changed	The speed of the vacuumizer is fixed and cannot be changed
The multi blades are bent. They seem defective	The multi blades are bent upwards and downwards. They can be used
The blades come loose	Slightly adjust the pins of the knives with a tool. If they are fixed too tightly, assembling and disassembling can be hard
The appliance stops during use	The appliance automatically stops when continuously used or if there are too much ingredients. Allow the appliance to rest for 3-4 minutes

If the problem persists, contact the after sales service (see chapter Warranty/After sales).

## ENVIRONMENT

- For your safety this appliance has been built in accordance with the European CE safety standards and is compliant with the general recognized standards and prescriptions with regard to the safety of electrical appliances. As for all electrical appliance, the necessary precautions need to be taken in order to avoid accidents or damages.
- Let's participate in the protection of the environment! Electrical appliances cannot in any way be disposed in a public waste bin or with normal domestic waste, but they must be brought to an official collection centre for recycling of electric and electronic appliances. For more information on the collection centres for recycling of appliances at the end of their lifetime, please contact the local authorities in your area, the household waste disposal service provider or the store where you bought your appliance



## WARRANTY

Dalcq S.A. provides a special warranty on all parts of the appliance subject to conditions below. The legal regulations about warranty as well as the rights resulting from the legislation about responsibility of the defective products remain unaffected. Possible right to reimbursement of the buyer in case of defaults remain valid, if the conditions below are met.

### 1. Period of the warranty

The warranty applies to all parts of the appliance and starts from the date of purchase (date of invoice) of the appliance and has a duration of 2 years when used privately.

### 2. Object of the warranty

Dalcq S.A. covers the material, construction and manufacturing defaults, provided the default was present at delivery and that the appliance was correctly operated by the buyer. The warranty covers free of charge repair, or exchange of one or more defective components, or the exchange of the appliance for another appliance of the same value. It is up to Dalcq S.A. to decide which measure to undertake.

### 3. Warranty case

When breakdown/default, you must immediately advise:

- The store where you bought the appliance
- The after sales service (written or via email) that the appliance will be returned, to provide an extended description of the problem with pictures



#### **4. Packaging**

It is recommended to use the original packaging to return the appliance. If you use a different packaging, make sure it provides enough protection for typical transport risks and that it offers sufficient protection. A simple cardboard box filled with paper is not sufficient. Dalcq S.A. cannot be held responsible for damage resulting from insufficient packaging. The warranty then expires. The after sales service will inform you of the return procedure as well as of the costs this implies.

#### **5. Cleaning**

If you don't clean the parts or the appliance before returning it, Dalcq S.A. will invoice a cleaning set rate. It is the responsibility of the buyer to prove the real costs of cleaning are inferior to the invoiced set rate.

#### **6. Withdrawal of the right to warranty**

The right to warranty is withdrawn by:

- Incorrect use, treatment and storage. (for example, defaults caused by humidity, high temperatures)
- Repairs, repair attempts, modifications of any kind and use of non-original parts, etc. which were not executed by Dalcq S.A. or by an authorized company
- Insufficient packaging and bad transport
- Inappropriate mechanical influences on the appliance or on the parts of the appliance
- Defaults that are not caused by the finishing or production of the appliance, such as fall, collision, damage, fire, earthquake, damage by flood, lightning, etc
- Use other than household use, especially in a commercial environment
- The costs incurred by Dalcq S.A. because of the returning of the appliance by the buyer, without warranty or right to restitution will be for the buyer

#### **7. Service après-vente**

Dalcq S.A.

Rue du Hainaut 86 - 6180 Courcelles

Belgium

support@dalcq.com

frifri.**BE**